



**Rhine RO
Series**

Rhine RO Series Water Purification[※]

WR400.AY/WR600.AY

- Every drop of fresh, clean water comes from the last second of purified filtration
- Tankless design with large flow. Space saving and fast water discharge
- Four-stage filtration, Imported reverse osmosis membrane
- Efficiency production over 60%*
- Lead-free intelligent water purification tap as standard
- Double alert for filter life, easy replacement
- Precisely matched pump membranes, low noise
- Quality assurance through a full inspection system for high and low pressure tightness of the whole machine

◆ Real-time digital display, double alert

High precision sensors, integrated control system

Built-in intelligent water leak protector, detects water leak signal and automatically cuts off water

Intelligent faucet with built-in Hall sensor, more accurate water control.

Independent monitoring of four filters' life, three primary color indicators to remind in real time



- Filter work normally
- Filter replacement alert
- Filter replacement notice

Smart faucet display



- Filter work normally
- Filter replacement alert
- Beeping and flashing alarm when forced strong stop or water leakage (Synchronised flashing of the cartridge life index when water leakage)
- Filter replacement notice



◆ EZ-Level™ filter replacement system, DIY replacement, saving time and effort

Magnetic housing for quick opening without the use of tools and a patented design .

Patented lever principle for effortless cartridge change, easy to replace by rotating 90°.

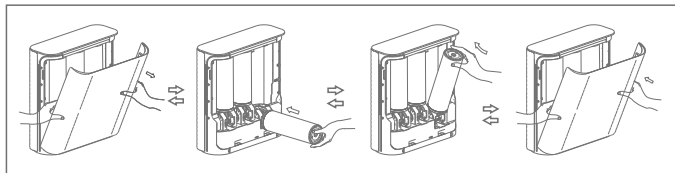

◆ Four-stage high efficiency filtration

Protecting your family's drinking water health

Effective filtering of heavy metals, limescale, residual chlorine and other harmful substances.

